

DYNAFLAIR

SLIDING CLOSURE
(#8) EMEEGENCY EGRESS
(OPERATION)

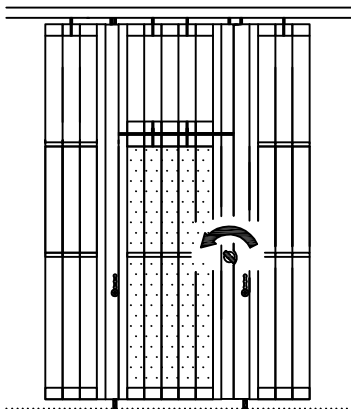

1st



ROTATE THUMBTURN
(OR LEVER) THROUGH
90 DEGREES OF TRAVEL
TO RELEASE HOOKBOLT

2nd

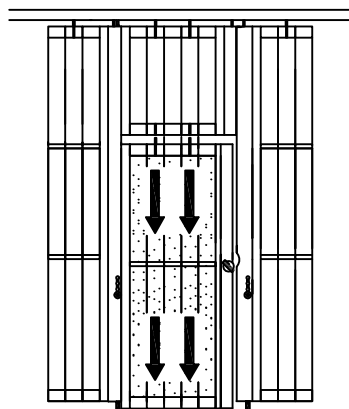

MAN DOOR INSERT
DROPS DOWN FREE
OF FOLDING PANEL
SECTIONS ABOVE

3rd

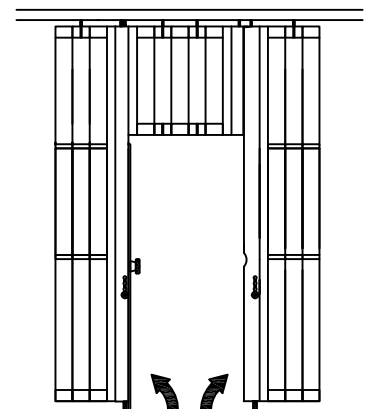

MAN DOOR INSERT
SWINGS OUT ON
A VERTICAL AXIS
IN THE DIRECTION
OF EGRESS